

## Features

- Capacities 15tf – 200tf.
- Linearity  $\pm 1\%$  RO.
- IP54/IP67 rating.
- Optional hardened washers.

## Applications

- Heavy duty weighing.
- Monitoring bolt torque forces.
- Virtually all industries.



## Description

The C-ALC is a large bobbin style design load cell produced from aluminium or stainless steel, depending on the capacity. PCM can also supply optional hardened washers for bolt torque monitoring projects.

## Typical Specification

PARAMETER	VALUE		UNITS
Capacities Range	15, 20, 30, 50,	100, 200	tf
Rated Output	1-2		mV/V
Linearity and Non-Repeatability	1-2		$\pm\%$ of Rated Output
Zero Balance	5.0		$\pm\%$ of Rated Output
Input Impedance	700 $\pm$ 10		$\Omega$
Output Impedance	700 $\pm$ 10		$\Omega$
Insulation Resistance	>2		G $\Omega$
Excitation <small>RECOMMENDED</small>	10		Volts AC or DC
Excitation <small>MAXIMUM</small>	15		Volts AC or DC
Temperature Range <small>OPERATING</small>	-10 to +80		$^{\circ}\text{C}$
Temperature Range <small>COMPENSATED</small>	-10 to +70		$^{\circ}\text{C}$
Temperature Effect <small>ON OUTPUT</small>	0.1		$\pm\%$ of Rated Output/ $^{\circ}\text{C}$
Temperature Effect <small>ON ZERO</small>	0.02		$\pm\%$ of Rated Output/ $^{\circ}\text{C}$
Mechanical Limit <small>SAFE OVERLOAD</small>	150		% of Rated Output
Mechanical Limit <small>ULTIMATE OVERLOAD</small>	300		% of Rated Output
Cable Length	5		m
Sensor Construction Material	Aluminium	Stainless Steel	-
Environmental Protection	IP54	IP67	-

## Outline Dimensions in millimetres

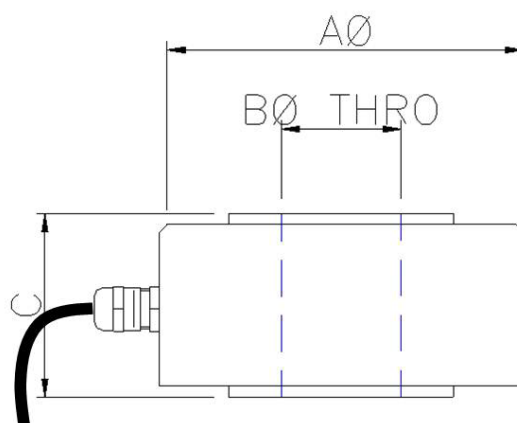

## Annular Compression Load Cell

CAPACITY (tf)	ØA	ØB	C
15	152	95	98
20	152	95	98
30	152	95	98
50	152	95	98
100	152	95	98
200	152	95	98

*If the dimensions or specification do not suit, PCM has an in-house design team that should be able to satisfy your requirements.*

### Wiring Details

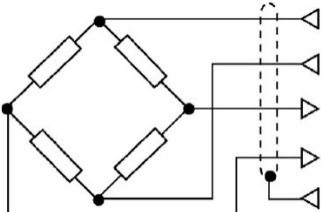
SCHEMATIC DIAGRAM	OUTPUT	CABLE
	EXCITATION +	RED
	EXCITATION -	BLUE
	OUTPUT +	GREEN
	OUTPUT -	YELLOW
	-----	SHIELD

*7/0.2 4-core screened cable, polyurethane sheath. Shield connected to the body of the load cell.*

### Loading Mode

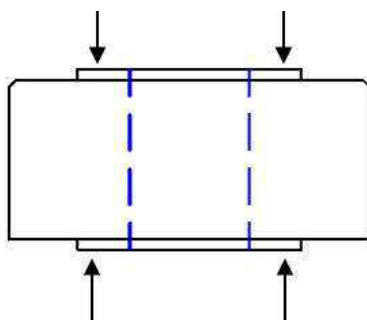

### Disclaimer

Modifications reserved. All details describe our products in general form only. PCM assumes no liability whatsoever and disclaims any express or implied warranty relating to sales and/or use of PCM products including liability or warranties relating to fitness for a particular purpose.